

# TLM-407JF LCD PANEL HOLDER



## Instruction Manual

## Package Contents:

The following items should be included in the box. If any items are missing please contact your supplier.

1 x Base Plate



1 x Right Side Plate

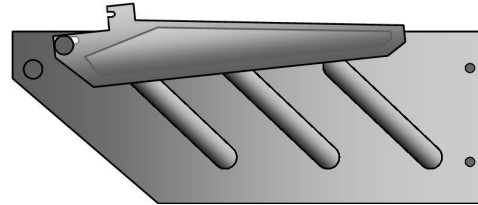

1 x Left Side Plate

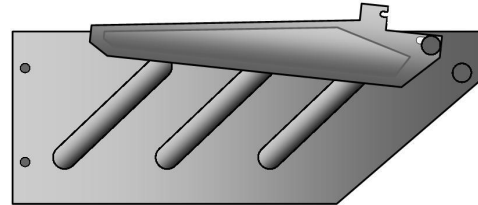

4 x Side Panel Screws



8 x Thumb Screws



2 x Base Plate Screws



## Assembly

### Mounting the TLM-407JF on an SE-800

N.B. The Base Plate goes beneath the feet of the SE-800 – **DO NOT** mount the Base Plate between the feet and the SE-800 bottom case, as this may cause damage to the SE-800. *When assembled correctly the Holder Bottom Plate should sit on the desk, with the SE-800 feet between the Base Plate and the SE-800 Bottom Case.*

Carefully turn the SE-800 upside down and remove the screws from the two rear feet. Leave the feet in place.



Position the Base Plate so that the two screw holes align with the rear feet of the SE-800 - *Note the rear feet of the SE-800 are still in position.*



Use the two Base Plate screws to attach the Bottom Plate to the Base of the SE-800 – *Note the rear feet of the SE-800 are still in position.*



Carefully return the SE-800 to an upright position and attach the Left Side Panel to the Base Plate using 2 x Side Panel Screws

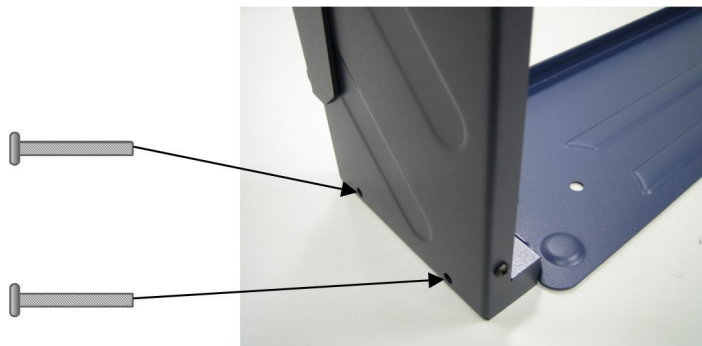

Attach the Right Side Panel to the Base Panel using 2 x Side Panel Screws.

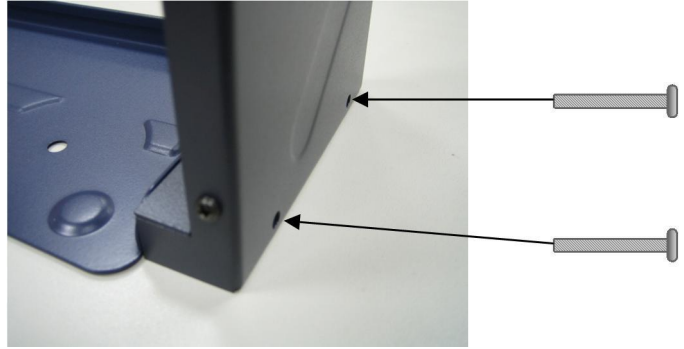

Loosen the two Thumb Screws at the top of both of the Side Panels – There is no need to remove them.

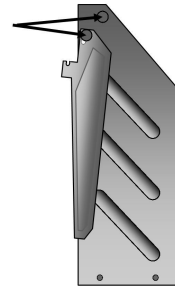

The Upper Mounting Plate Swivels around the lower Thumb Screw. Rotate the Upper Mounting Plate to an upright position and then drop it into place, so that it sits correctly on the second Thumb Screw. Once in position, tighten the Thumb Screws to secure.

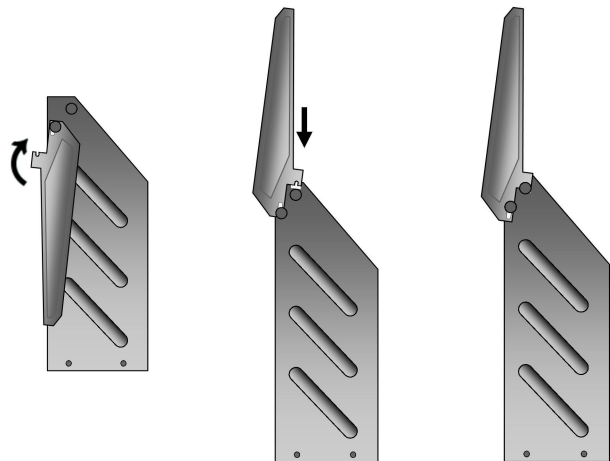

Now fix the monitors into position using the 8 x Thumb Screws supplied.



# Service and Support

It is our goal to make your products ownership a satisfying experience. Our supporting staff is available to assist you in setting up and operating your system. Please refer to our web site [www.datavideo-tek.com](http://www.datavideo-tek.com) for answers to common questions, support requests or contact your local office below.

## Datavideo Corporation (USA)

12300-U East Washington Blvd., Whittier, CA 90606 USA

Tel: +1 562 696 2324

[contactus@datavideo.us](mailto:contactus@datavideo.us)

[www.datavideo.us](http://www.datavideo.us)

## Datavideo Technologies Europe BV

Californiedreef 26 3565 BL Utrecht, The Netherlands

Tel: +31 30 261 9656

[info@datavideo.nl](mailto:info@datavideo.nl)

[www.datavideo.info](http://www.datavideo.info)

## Datavideo UK Limited

Unit 2 Waterside Business Park, Hadfield, Glossop, Derbyshire SK13 1BE UK

Tel: +44 1457 851000

[sales@datavideo.co.uk](mailto:sales@datavideo.co.uk)

[www.datavideo.info](http://www.datavideo.info)

## Datavideo Technologies Co., Ltd.

10F, 176 Jian-Yi Rd, Chung Ho City, Taipei Hsien, Taiwan 235

Tel: +886 2 8227 2888

[service@datavideo.com.tw](mailto:service@datavideo.com.tw)

[www.datavideo.com.tw](http://www.datavideo.com.tw)

## Datavideo Technologies China Co.

2F-D, 2 Lane 777, West Guangzhong Rd, Zhabei District, Shanghai, China

Tel: +86 21 5603 6599

[service@datavideo.cn](mailto:service@datavideo.cn)

[www.datavideo.cn](http://www.datavideo.cn)

## Datavideo Technologies (S) PTE Ltd.

No. 100, Lorong 23 Geylang, #01-03 D'Centennial Bldg, Singapore 388398

Tel: +65 6749 6866

[info@datavideo.sg](mailto:info@datavideo.sg)

[www.datavideo.info](http://www.datavideo.info)

## Datavideo Hong Kong Limited

G/F., 26 Cross Lane, Wanchai, HK

Tel: +852 2833 1981

[info@datavideohk.com](mailto:info@datavideohk.com)

[www.datavideohk.com](http://www.datavideohk.com)